

<b>Bike</b>	Honda MSX 125	<b>Part No.</b>	PHA-199-SYS
<b>Year</b>	2021-Current	<b>Fit Kit</b>	Z039.10716
<b>Notes</b>	Where not supplied use original fittings.	<b>dB Killer</b>	SCEXDBK49 (TYPE PD)

Estimated Fitting Time: 30 Minutes

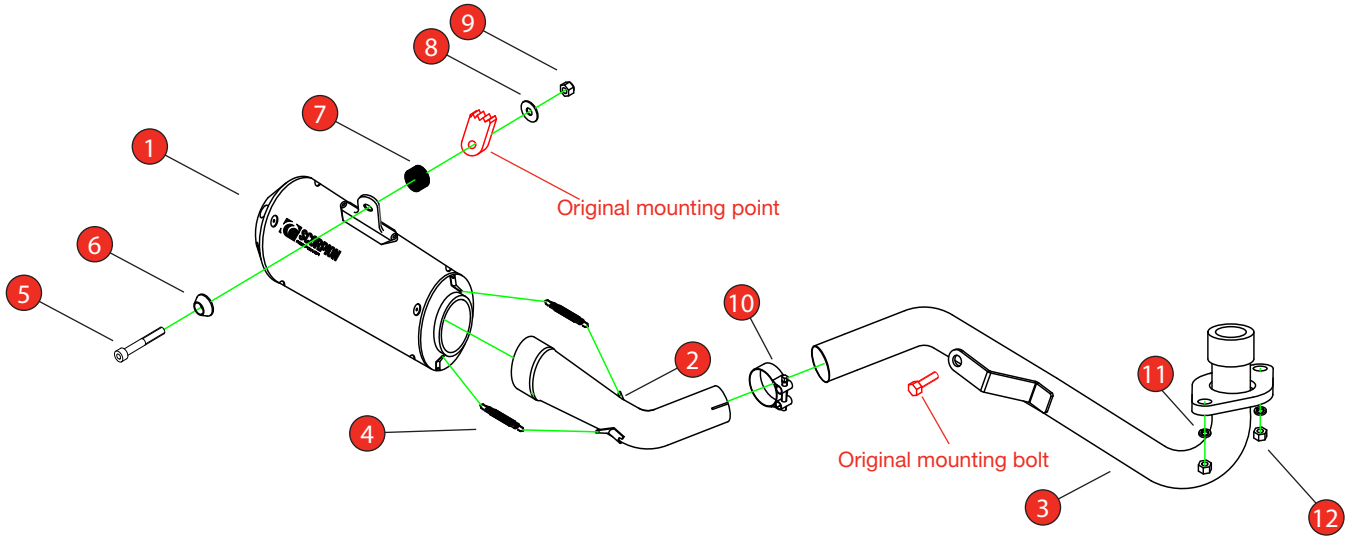

NO.	PART NO.	DESCRIPTION	QTY
1	PSC445	Red Power Silencer	1
2	CP1166	Connecting Pipe	1
3	CP1165	Header Pipe	1
<b>Fit Kit - Z039.10716</b>			
4	Z028.10030	Rubber Coated Spring	2
5	Z017.10082	M8 x 70 Cap Head Bolt	1
6	Z026.20068B	Black Alloy Bolt Finisher	1
7	Z026.20181	Black 15mm Spacer	1
8	Z017.10825	M8 x 25mm Washer	1
9	Z017.10062	M8 Nyloc Nut	1
10	Z016.10006	37-40mm Clamp	1
11	Z017.10064	M8 Spring Washer	2
12	Z017.10826	M8 Nut	2

CLASSIFICATION	Closed Circuit Product
HOMOLOGATED	NO
DATE	14/09/2022
ISSUE	00
AUTHORISED	S Shipley

**NOTE:** ENSURE SCORPION SYSTEM IS CLEAR OF MOVING PARTS AND ALL ORIGINAL FUNCTIONS WORK CORRECTLY.

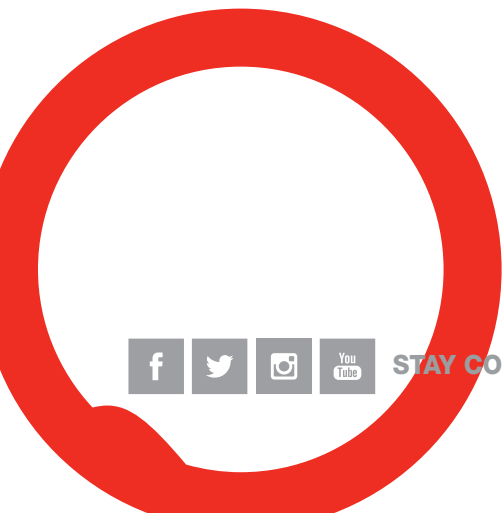

STAY CONNECTED TO RED POWER.

<b>Bike</b>	Honda MSX 125	<b>Part No.</b>	PHA-199-SYS
<b>Year</b>	2021-Current	<b>Fit Kit</b>	Z039.10716
<b>Notes</b>	Where not supplied use original fittings.	<b>dB Killer</b>	SCEXDBK49 (TYPE PD)



A) Start by loosening the clamp between the header pipe and the rear silencer.

B) Remove the nut on the back of the silencer mounting point, then support the weight of the silencer and remove the mounting bolt.

C) Carefully remove the rear silencer from the bike.

D) Remove the header pipe mounting bolt.



E) Whilst supporting the weight of the header pipe loosen and remove the header flange nuts.

F) Remove the header pipe. You may find that the header studs are corroded, if they are we recommend cleaning these up with a wire brush or if you have one, a die tool.

G) Slide the header pipe onto the header studs.

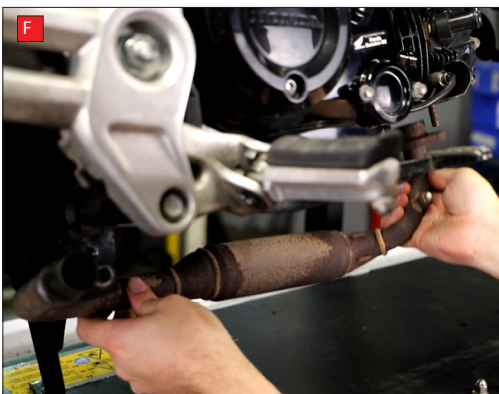

H) The supplied spring washers and nuts can now be used to hold the header in place. Do NOT fully tighten them at this stage.

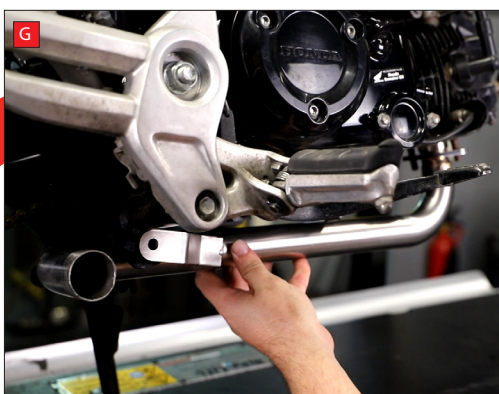



<b>Bike</b>	Honda MSX 125	<b>Part No.</b>	PHA-199-SYS
<b>Year</b>	2021-Current	<b>Fit Kit</b>	Z039.10716
<b>Notes</b>	Where not supplied use original fittings.	<b>dB Killer</b>	SCEXDBK49 (TYPE PD)

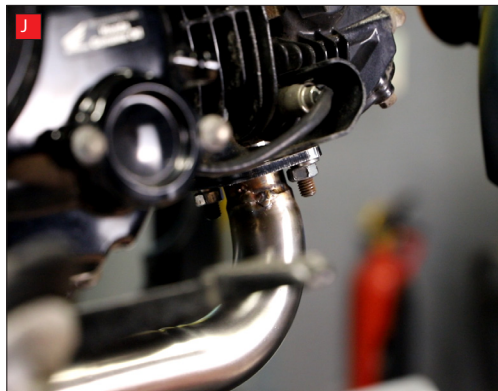

I) Line the hole in the mounting bracket up with the original mounting point on the frame and then screw the original mounting bolt in a couple of turns.

J) Ensure the header is lined up correctly with the port in the head and then fully tighten the header nuts.

K) Fully tighten the header mounting bolt.



L) Slide the connecting pipe onto the header pipe. You don't need to slide it on all the way as you will adjust it to the correct position later on.

M) Slide the silencer onto the connecting pipe, put the spacer between the mounting bracket on the silencer and the mounting point on the bike then attach with the supplied hardware. The diagram on the first page shows which hardware to use.

Leave loose for now to allow for adjustment.



N) Fit the springs between the silencer and the connecting pipe.

O) Position the connecting pipe so that the silencer is aligned correctly and then tighten the clamp between the connecting pipe and the header pipe.

P) Fully tighten the silencer mounting bolt.



Take the bike for a short ride to ensure it functions as it should. Once the bike and exhaust are cool enough check all nuts and bolts are still secure.

<b>Bike</b>	Honda MSX 125	<b>Part No.</b>	PHA-192-SYS
<b>Year</b>	2021-Current	<b>Fit Kit</b>	Z039.10716
<b>Notes</b>	Where not supplied use original fittings.	<b>dB Killer</b>	SCEXDBK49 (TYPE PD)

Estimated Fitting Time: 30 Minutes



Thank you for purchasing your Scorpion Silencer.

Care of your exhaust: Please refrain from cleaning silencer with heavy solvents or abrasives!

Vielen Dank Für den kauf eines Scorpion Schalldampfers! Pflegehinweis: Bitte verwenden Sie niemals Scheuermittel oder aggressive Reiniger zur Pflege Ihres Auspuffes!

Merci d'avoir choisi un echappement Scorpion.

Entretien de votre silencieux: Ne pas utiliser de solvants ou de produits abrasifs!

Muchas gracias por adquirir un Silencioso Scorpion. Le recomendamos no limpiar el silencioso con productos abrasivos o aquellos que contengan disolventes.



STAY CONNECTED TO RED POWER.